

eXP2

HUMAN MACHINE INTERFACE

4.3" ~ 10.1"



HmT
mechatronics

LS ELECTRIC



Human Machine Interface eXP2 Series

The eXP2 HMI is a technology that allows interaction between humans and machines, typically in industrial or automation settings. It serves as a visual gateway for operators and engineers to monitor, control, and manage various processes and equipment. The eXP2 offers more convenient control.

Project Downloading

The project downloading speed of the LS Electric eXP2 HMI is twice as swift as that of its predecessor, the eXP.

Screen Change

The transition speed of the LS Electric eXP2 HMI's screen changes is quadrupled (4 times faster) compared to the eXP.

Booting

The eXP2 HMI has an improved boot-up time. Specifically, it takes 1.2 times less time to complete the boot-up process. In other words, the eXP2 HMI starts up approximately 20% faster than the reference device.

Graphic Rendering

The LS Electric eXP2 HMI excels in graphic rendering, boasting a rendering speed twice as fast as the eXP. This advancement results in smoother and more responsive display of real-time data, charts, and animations. Operators benefit from an enhanced user experience, reduced lag, and improved productivity, making it particularly valuable in industries requiring quick decision-making based on visual information.

Communication Driver

Various communication drivers (continuously being added).

Compatibility

The LS Electric eXP2 HMI appears to offer compatibility with the eXP platform, likely accommodating existing panel cuts and project files. Its compatibility with various PLCs suggests support for multiple communication protocols, drivers, and tag integration, enabling seamless data exchange and control across different PLC brands and models in industrial settings. For precise details on compatibility and functionality, it is recommended to refer to LS Electric's official documentation or contact their support.

LCD Life Time

The LCD longevity of the LS Electric eXP2 HMI has been significantly enhanced, now boasting an impressive extension of 2.5 times its previous duration.



Portrait Mode



- Vertical mounting is available
- Setting in XP-Builder: [COMMON]-[Project Property Setting]

Item	eXP	eXP2
Vertical Mode	eXP20 Only	0
PDF Viewer	X	0
FTP Client	X	0
VNC Client	X	0

PDF Viewer



- PDF files can be displayed on XGT Panel.
- In the event of an alarm, the content of the alarm's trouble shooting can be checked on site as a PDF file.
- PDF files on an FTP server can be displayed using a PDF viewer object.

FTP Client

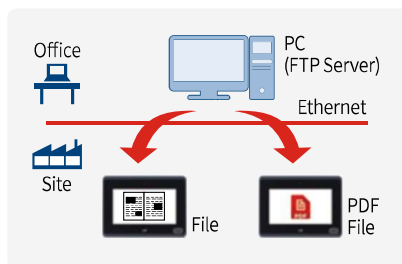

- FTP client is an object that can connect to the FTP server, display the list of files and directories on the FTP server, and download the selected file.
- PDF files on an FTP server can be displayed using a PDF viewer object.

VNC Viewer

- Remotely monitoring PC or HMI using VNC Viewer is available
 - Download VNC server to HMI using XP-Manager.
 - Install a universal VNC server on your PC.(Ultra VNC, Real VNC, etc.)
- Add 'VNC Viewer' object to the project screen.

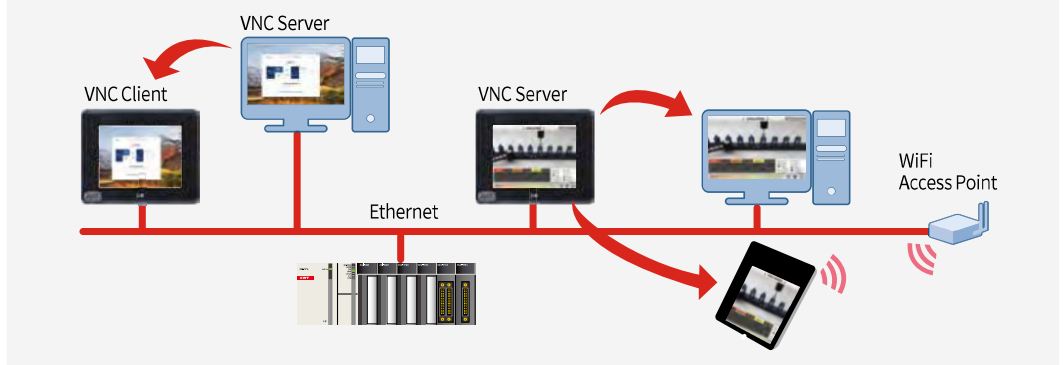

Specifications



hmtmechatronics.com



Item		eXP2-04□*0D	eXP2-10□*0D	eXP2-10□*1D
Display Type		TFT color LCD		
Screen Size		10.9cm (4.3")	25.9cm (10.1")	
Display Resolution		480 x 272 Pixel	1024 x 600 Pixel	
Color Indication		24Bit Color (16.7M)	24Bit Color (16.7M)	
Indication Degree		Left/Right: 60 deg. Upper: 40 deg. Lower: 50 deg	Left/Right: 70 deg. Upper: 50 deg. Lower: 70 deg.	
Backlight		LED Type (Supports Backlight Auto-off Function)		
Backlight Duration		50,000 Hours	30,000 Hours	
Touch Panel		4-Wire Resistive, Analog		
Audio Output		Magnetic Buzzer (85dB)		
Process		800MHz		
Memory	Drawing Memory	64MB		
	Operating RAM	512MB		
	Backup RAM	128KB		
Backup Data		Date/Hour Data, Logging/Alarm/Recipe Data and Nonvolatile Device		
Battery Life		Approx. 3 years (Operating Ambient Temperature of 50°C)		
Ethernet		1 Channel, IEEE802.1a, 10Base-T/100Base-TX		-
USB Host		1 Channel, USB 2.0 Host (Mouse, keyboard, printer, USB flash drive, etc.)		
USB Device		-	1 Channel, USB 2.0 Device (for Download and Upload Project)	
Micro SD Card			-	1 Channel SDHC Class10
RS-485, RS-232C		1 Channel, RS-232C (DSUB 9/Male Type)	2 Channels, RS-485, RS-232C (DSUB 9/Male Type)	
RS-422/485		1 Channel, RS-422/485 (DSUB 9/Male Type)		
Multi-language		Up to 12 Language Simultaneously		
Animation		GIF Format is Available		
Recipe		Available		
Data Logging		Available		
Script Executor		Available		
Certifications		CE, UL(cUL), UL Type 4X, KC	CE, UL(cUL), UL Type 4X, KC	CE, UL(cUL), KC
Protection Standard		IP65 <small>Note 1)</small>		
Dimension (mm)		128 x 102 x 32.5	276 x 218 x 35.1	
Panel Cut (mm)		119 x 93	260 x 202	
Rated Voltage		DC24V		
Power Consumption (W)		4	6	
Weight (kg)		0.27	1.0	

□*0 (WinCE 7.0 Core), 1 (WinCE 7.0 Pro) 1) IP66 for UL TYPE 4X models.

eXP2-04 (4.3")

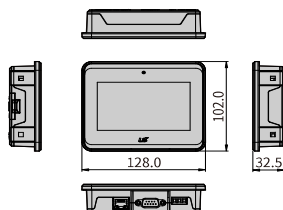

eXP2-10 (10.1")

